

CYLINDRICAL MOUNTINGS • TO 75 lbf



FOR COMPRESSION LOADS OF 40 TO 75 lbf
SHEAR LOADS OF 19 TO 42 lbf

PHONE: 516.328.3300 • FAX: 516.326.8827 • WWW.SDP-SI.COM

> MATERIAL:

Fastener - Steel, Zinc Plated
Isolator - Natural Rubber

> NOTE:

Maximum unthreaded portion of stud does not exceed 1/16 inch.

> LOAD DEFLECTION GRAPHS:

Deflections below the line x-x are considered safe practice for static loads; data above that line are useful for calculating deflections under dynamic loads.

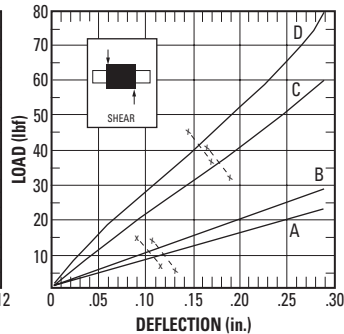
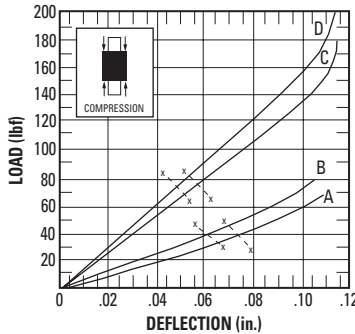
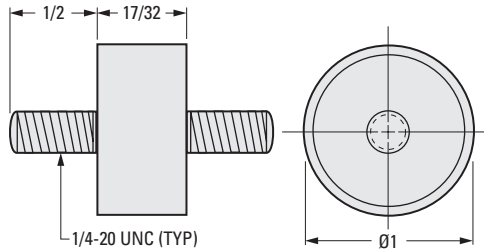
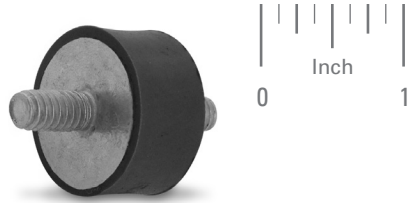

INCH COMPONENT CATALOG NUMBER

A 10 Z 2 - 305

Load Rating
A, B, C or D

Compression		Forcing Frequency in Cycles per Minute									
Load Rating	Maximum Load lbf	1100	1250	1500	1750	2000	2250	2500	2750	3000	3600
		Minimum Load for 81% Isolation (lbf)									
A	40	—	—	—	—	30.5	24.0	19.5	16.0	13.5	10.0
B	43	—	—	—	—	38.0	30.0	24.8	20.5	17.5	12.5
C	74	—	—	—	—	74.0	58.5	47.5	39.5	33.0	23.5
D	75	—	—	—	—	—	67.5	55.5	45.5	38.5	27.5

Shear		Forcing Frequency in Cycles per Minute									
Load Rating	Maximum Load lbf	1100	1250	1500	1750	2000	2250	2500	2750	3000	3600
		Minimum Load for 81% Isolation (lbf)									
A	19	15.7	12.5	8.3	6.3	*	*	*	*	*	*
B	21	19.0	15.5	10.6	8.0	6.3	5.0	*	*	*	*
C	37	—	31.5	22.5	17.0	14.0	11.5	9.5	*	*	*
D	42	—	40.0	29.2	22.0	18.5	15.8	13.0	11.0	9.5	*

* At these forcing frequencies, lesser loads will yield less than 81% isolation.

8-22
D820

REV:
4/20/23

