

FOR COMPRESSION LOADS OF 33 TO 79 lbf
SHEAR LOADS OF 18 TO 40 lbf

PHONE: 516.328.3300 • FAX: 516.326.8827 • WWW.SDP-SI.COM

► MATERIAL:

Fastener - Steel, Zinc Plated
Isolator - Natural Rubber

► NOTE:

Maximum unthreaded portion of stud does not exceed 1/16 inch.

► LOAD DEFLECTION GRAPHS:

Deflections below the line x-x are considered safe practice for static loads; data above that line are useful for calculating deflections under dynamic loads.

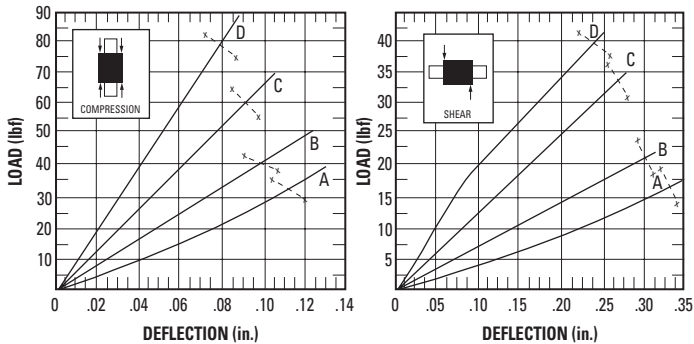
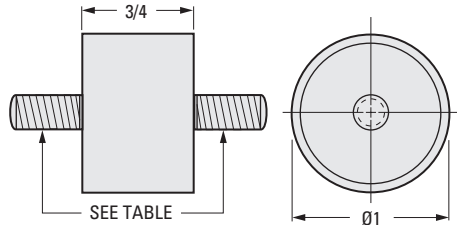

INCH COMPONENT CATALOG NUMBER

A 1 0 Z 2-
Thread Code Load Rating
300 A, B, C or D
317

Thread Code	Thread UNC	Thread Length
300	1/4 - 20	1/2
317	5/16 - 18	9/16

Compression		Forcing Frequency in Cycles per Minute									
Load Rating	Maximum Load lbf	850	1100	1250	1500	1750	2000	2250	2500	3000	3600
		Minimum Load for 81% Isolation (lbf)									
A	33	—	—	—	29.0	21.0	16.0	12.5	10.5	7.0	5.0
B	40	—	—	—	39.5	28.5	21.5	17.0	14.0	9.5	7.0
C	60	—	—	—	—	49.0	37.0	29.5	24.0	17.0	11.5
D	79	—	—	—	—	72.5	55.0	43.5	36.0	24.5	17.0

Shear		Forcing Frequency in Cycles per Minute									
Load Rating	Maximum Load lbf	850	1100	1250	1500	1750	2000	2250	2500	3000	3600
		Minimum Load for 81% Isolation (lbf)									
A	18	16.0	9.3	7.2	5.0	3.8	2.8	2.3	1.8	1.2	*
B	21	—	13.0	10.2	7.0	5.3	4.0	3.2	2.6	1.8	*
C	34	—	24.5	20.0	14.7	11.2	9.0	7.5	6.2	4.5	3.5
D	40	—	32.0	26.0	19.0	14.8	12.0	10.0	8.3	6.0	5.0

* At these forcing frequencies, lesser loads will yield less than 81% isolation.