

FOR COMPRESSION LOADS OF 41 TO 120 lbf
SHEAR LOADS OF 21 TO 63 lbf

PHONE: 516.328.3300 • FAX: 516.326.8827 • WWW.SDP-SI.COM

> MATERIAL:

- Fastener - Steel, Zinc Plated
- Isolator - Natural Rubber

> LOAD DEFLECTION GRAPHS:

Deflections below the line x-x are considered safe practice for static loads; data above that line are useful for calculating deflections under dynamic loads.

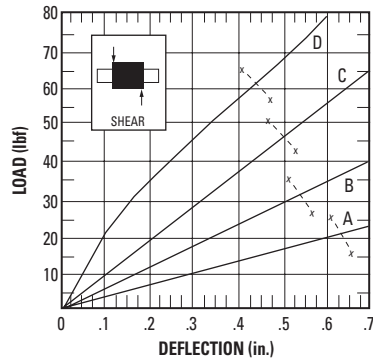
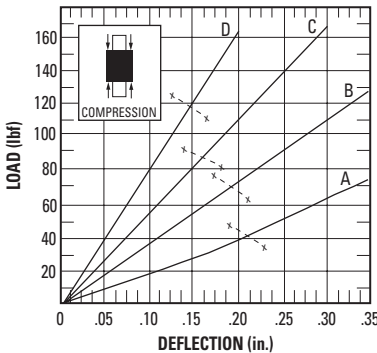
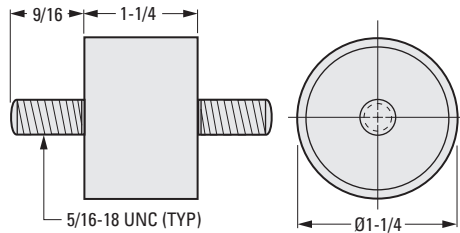
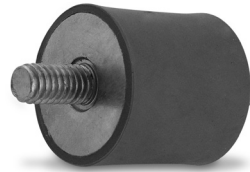

**INCH COMPONENT
CATALOG NUMBER**

A 10Z 2-310

Load Rating
A, B, C or D

Compression		Forcing Frequency in Cycles per Minute									
Load Rating	Maximum Load lbf	600	850	950	1100	1250	1500	1750	2000	2500	3000
		Minimum Load for 81% Isolation (lbf)									
A	41	—	—	—	34.5	27.5	19.0	14.0	10.0	7.0	—
B	64	—	—	—	—	48.0	32.0	24.0	17.5	12.0	8.5
C	90	—	—	—	—	80.0	55.0	41.5	30.0	20.0	14.0
D	120	—	—	—	—	—	89.0	70.5	53.0	38.5	26.5

Shear		Forcing Frequency in Cycles per Minute									
Load Rating	Maximum Load lbf	600	850	950	1100	1250	1500	1750	2000	2500	3000
		Minimum Load for 81% Isolation (lbf)									
A	21	20.0	11.0	8.5	6.7	5.5	*	*	*	*	*
B	31	—	18.0	14.0	10.5	8.0	5.5	*	*	*	*
C	48	—	31.5	25.0	19.5	15.5	11.0	8.5	*	*	*
D	63	—	50.0	41.0	32.6	27.5	20.5	16.0	14.0	8.0	*

* At these forcing frequencies, lesser loads will yield less than 81% isolation.