

CYLINDRICAL MOUNTINGS • TO 210 lbf



FOR COMPRESSION LOADS OF 95 TO 210 lbf
 NOT RECOMMENDED FOR STATIC SHEAR LOADS

PHONE: 516.328.3300 • FAX: 516.326.8827 • WWW.SDP-SI.COM



► **MATERIAL:**

Fastener - Steel, Zinc Plated
Isolator - Natural Rubber

► **LOAD DEFLECTION GRAPHS:**

Deflections below the line x-x are considered safe practice for static loads; data above that line are useful for calculating deflections under dynamic loads.

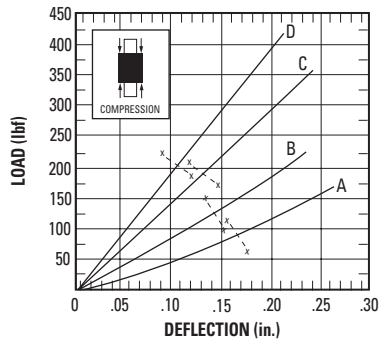
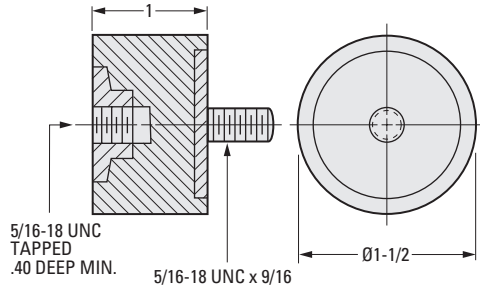

INCH COMPONENT CATALOG NUMBER

A 10Z 2-308

Load Rating
 A, B, C or D

Compression		Forcing Frequency in Cycles per Minute						
Load Rating	Maximum Load lbf	1150	1250	1500	1750	2000	2750	3500
		Minimum Load for 81% Isolation (lbf)						
A	95	95	80	55	40	30	15	—
B	135	—	120	85	60	45	22	—
C	185	—	—	140	100	75	40	25
D	210	—	—	185	135	105	55	35

8-29
 D820

Rev:
 3/28/23

