

> MATERIAL:

Cam - Acetal, Black  
Insert - Brass

> SPECIFICATIONS:

Cams with:  
.125 bore have a #2-56 set screw & spot drill.  
.188 bore have a #4-40 set screw & spot drill.



SDPSI • SDPSI • SDPSI

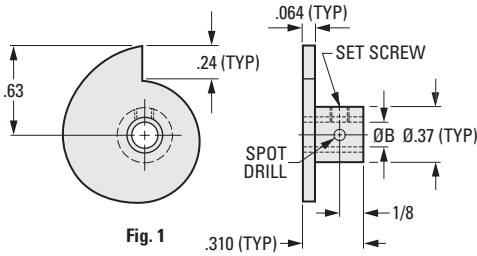
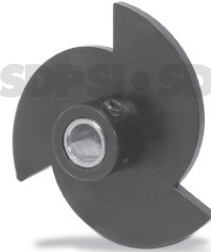

Fig. 1

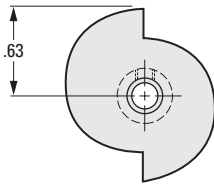

Fig. 2

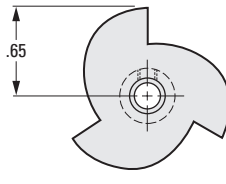

Fig. 3

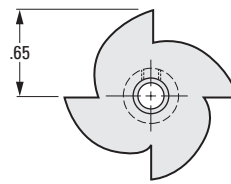

Fig. 4

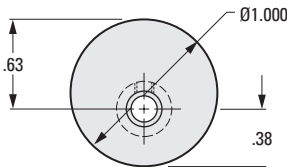

Fig. 5

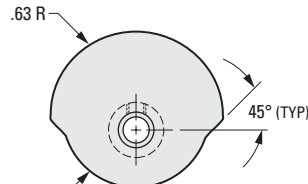

Fig. 6

**INCH COMPONENT**

Catalog Number	Fig. No.	B Bore +.001 -.000	Rise per 15°
A 3Y 3-1204	1	.125	.010
A 3Y 3-1206		.188	
A 3Y 3-2204	2	.125	.020
A 3Y 3-2206		.188	
A 3Y 3-3204	3	.125	.030
A 3Y 3-3206		.188	
A 3Y 3-4204	4	.125	.040
A 3Y 3-4206		.188	
A 3Y 3-5204	5	.125	—
A 3Y 3-5206		.188	
A 3Y 3-6204	6	.125	—
A 3Y 3-6206		.188	