

SPROCKETS FOR ROLLER CHAIN • 6.35 mm PITCH



FOR SINGLE STRAND CHAINS
2.8 mm FACE

PHONE: 516.328.3300 • FAX: 516.326.8827 • WWW.SDP-SI.COM



► **MATERIAL:**
AISI C 1045 Steel

► **SPECIFICATION:**
These sprockets can be used with standard #25, 1/4" pitch roller or ladder chains.

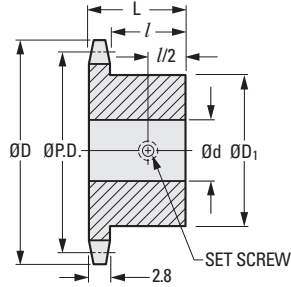

METRIC COMPONENT

Catalog Number	No. of Teeth	P.D.	D Dia. (Ref.)	d Bore	L Length	D ₁ Hub Dia.	l Hub Proj.	Set Screw
A 6C 7MHK2508	8	16.6	19.1	6	12.8	10	10	M4
A 6C 7MHK2509	9	18.6	21.3	6	12.8	10	10	M4
A 6C 7MHK2510	10	20.5	23.4	8	12.8	14	10	M4
A 6C 7MHK2511	11	22.5	25.4	8	12.8	16	10	M4
A 6C 7MHK2512	12	24.5	27.5	8	12.8	18	10	M4
A 6C 7MHK2513	13	26.5	29.6	8	12.8	20	10	M4
A 6C 7MHK2514	14	28.5	31.6	8	12.8	22	10	M4
A 6C 7MHK2515	15	30.5	33.7	8	12.8	22	10	M4
A 6C 7MHK2516	16	32.5	35.7	8	14.8	26	12	M4
A 6C 7MHK2517	17	34.6	37.8	8	14.8	26	12	M4
A 6C 7MHK2518	18	36.6	39.8	8	14.8	28	12	M4
A 6C 7MHK2519	19	38.6	41.9	8	14.8	28	12	M4
A 6C 7MHK2520	20	40.6	43.9	8	17.8	28	15	M4
A 6C 7MHK2521	21	42.6	45.9	8	17.8	35	15	M4
A 6C 7MHK2522	22	44.6	48	8	17.8	35	15	M4
A 6C 7MHK2523	23	46.6	50	8	17.8	35	15	M4
A 6C 7MHK2524	24	48.6	52	8	17.8	35	15	M4
A 6C 7MHK2525	25	50.7	54.1	8	17.8	35	15	M4
A 6C 7MHK2526	26	52.7	56.1	10	18	35	15.2	M5
A 6C 7MHK2528	28	56.7	60.2	10	18	38	15.2	M5
A 6C 7MHK2530	30	60.7	64.2	10	18	38	15.2	M5
A 6C 7MHK2532	32	64.8	68.3	12	18	42	15.2	M5

Root Dia. = P.D. -3.3