

2 mm FACE

PHONE: 516.328.3300 • FAX: 516.326.8827 • WWW.SDP-SI.COM

► **MATERIAL:**

Ladder Chain - High-Tensile Stainless Steel or Stainless Steel  
Sprocket - Brass

► **SPECIFICATION:**

Bore Tolerance: +0.018/0

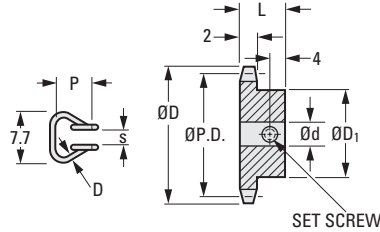
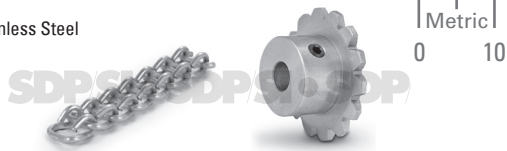

Fig. 1

Fig. 2

**METRIC COMPONENT**

| Catalog Number                                 | Material                                 | P Pitch | Links Per Meter | D Wire Dia. | s Inside Width | Yield Point N |
|--|--|---------|-----------------|-------------|----------------|---------------|
| <b>Fig. 1 Ladder Chains - Priced Per Meter</b> |  |         |                 |             |                |               |
| A 6C88M480                                     | High-Tensile Stainless Steel, 400 Series | 4.8     | 208             | 1           | 2.6            | 245           |
| A 6Y 8M480                                     | Stainless Steel, 300 Series              |         |                 |             |                | 133           |

| Catalog Number                   | No. of Teeth | P.D. | D Dia. | d Bore | L  | D <sub>1</sub> Hub Dia. |
|----------------------------------|--------------|------|--------|--------|----|-------------------------|
| <b>Fig. 2 Sprockets With Hub</b> |              |      |        |        |    |                         |
| * A 6B 8MHK4810A                 | 10           | 15.5 | 17.7   | 4      | 10 | 11.5                    |
| * A 6B 8MHK4810B                 |              |      |        | 5      |    |                         |
| Δ A 6B 8MHK4810                  | 11           | 17   | 19.2   | 6      | 10 | 13                      |
| A 6B 8MHK4811                    |              |      |        |        |    | 14                      |
| A 6B 8MHK4812                    | 12           | 18.5 | 20.8   |        |    | 15                      |
| A 6B 8MHK4813                    | 13           | 20.1 | 22.4   |        |    | 17                      |
| A 6B 8MHK4814                    | 14           | 21.6 | 23.9   |        |    | 18                      |
| A 6B 8MHK4815                    | 15           | 23.1 | 25.5   |        |    | 19                      |
| A 6B 8MHK4816                    | 16           | 24.6 | 27     |        |    | 23                      |
| Δ A 6B 8MHK4820                  | 20           | 30.7 | 33.2   |        |    | 25                      |
| A 6B 8MHK4822                    | 22           | 33.7 | 36.3   |        |    |                         |

\* These items have an M3 set screw. All others have an M4 set screw.

Δ To be discontinued when present stock is depleted.

Root Dia.= P.D. - 1