

LADDER CHAINS & SPROCKETS • 8.9 mm PITCH

SDP/SI

SIZE 14
 MOLDED WITH METAL INSERT
 4.3 mm FACE

PHONE: 516.328.3300 • FAX: 516.326.8827 • WWW.SDP-SI.COM

> MATERIAL:

- Ladder Chain** - Galvanized Steel, Brass, High-Tensile Stainless Steel or Stainless Steel
- Sprocket** - Acetal, Black
- Insert** - Brass, Knurled

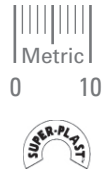

> SPECIFICATION:

- Sprockets with:**
- 4 mm bore have an M3 set screw & spot drill
- 6 mm bore have an M4 set screw & spot drill
- 8 mm bore have an M5 set screw & spot drill

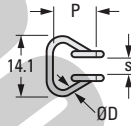

Fig. 1

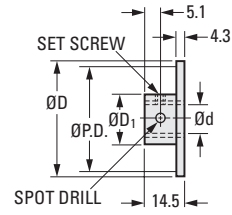

Fig. 2

METRIC COMPONENT

Catalog Number	Material	P Pitch	Links Per Meter	D Wire Dia.	s Inside Width	Yield Point N
Fig. 1 Ladder Chains - Priced Per Meter						
A 6C 8M14	Steel, Galvanized	8.9	112	2	5.2	353
A 6C88M14	High-Tensile Stainless Steel, 400 Series					667
A 6B 8M14	Brass					201
A 6Y 8M14	Stainless Steel, 300 Series					353

Catalog Number	No. of Teeth	P.D.	D Dia.	d Bore +0.025 0	D ₁ Hub Dia.	
Fig. 2 Sprockets						
A 6Z 8M141204	12	34.6	40.1	4	15.8	
A 6Z 8M141206				6		
A 6Z 8M141304				4		
A 6Z 8M141306	13	37.4	42.7	6		
A 6Z 8M141404				4		
A 6Z 8M141406				6		
A 6Z 8M141506	14	40.3	45.5	6		
A 6Z 8M141508				8		
A 6Z 8M141606				6		
A 6Z 8M141608	15	43.1	48.3	8		19
A 6Z 8M141608				6		15.8
A 6Z 8M141808				6		19
A 6Z 8M142008	16	46	50.8	8	19	
A 6Z 8M142208				6		
A 6Z 8M142408				8		
A 6Z 8M142508				6		
A 6Z 8M143008				8		
A 6Z 8M143208				6		
A 6Z 8M143608				8		
A 6Z 8M144008				6		
A 6Z 8M144808				8		

2-230
 D815

REV:
 3/29/24