

# CYLINDRICAL MOUNTINGS • TO 6 kgf



FOR COMPRESSION LOADS OF 2 TO 6 kgf  
SHEAR LOADS OF 1 TO 3 kgf

PHONE: 516.328.3300 • FAX: 516.326.8827 • WWW.SDP-SI.COM



### ► MATERIAL / FINISH:

**Fastener** - Steel, Zinc Plated  
**Isolator** - Natural Rubber

### ► NOTE:

Maximum unthreaded portion of stud does not exceed 1.59 mm.

### ► LOAD DEFLECTION GRAPHS:

Deflections below the line x-x are considered safe practice for static loads; data above that line are useful for calculating deflections under dynamic loads.

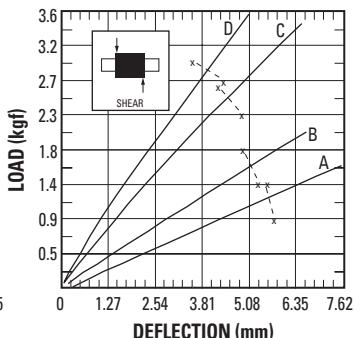
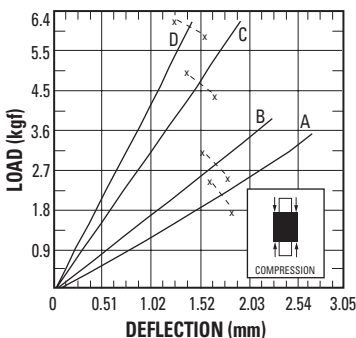
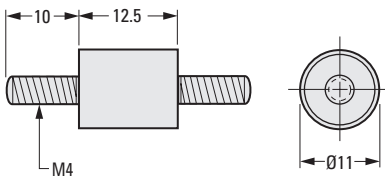
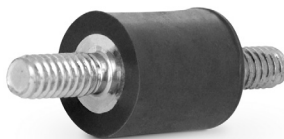

### METRIC COMPONENT CATALOG NUMBER

A 10 Z 2 M 302  M 410

Load Rating  
A, B, C or D

Compression		Forcing Frequency in Cycles per Minute									
Load Rating	Maximum Load kgf	1000	1250	1500	1750	2000	2250	2500	2750	3000	3600
		Minimum Load for 81% Isolation (kgf)									
A	2.2	-	-	-	-	1.8	1.4	1.1	0.9	0.8	0.5
B	2.9	-	-	-	-	2.4	1.9	1.5	1.3	1.1	0.7
C	4.7	-	-	-	-	4.5	3.5	2.9	2.4	2	1.2
D	6	-	-	-	-	5.9	4.7	3.9	3.2	2.6	1.9

Shear		Forcing Frequency in Cycles per Minute									
Load Rating	Maximum Load kgf	1000	1250	1500	1750	2000	2250	2500	2750	3000	3600
		Minimum Load for 81% Isolation (kgf)									
A	1.2	1.18	0.77	0.54	0.45	0.32	0.22	*	*	*	*
B	1.6	-	1.18	0.87	0.63	0.5	0.37	0.32	0.28	*	*
C	2.5	-	2.14	1.45	1.13	0.87	0.68	0.59	0.5	0.41	0.32
D	2.9	-	2.76	2	1.54	1.22	1	0.82	0.72	0.63	0.45

\*At these forcing frequencies, lesser loads will yield less than 81% isolation.

I

R

T

1

2

3

4

5

6

7

8

9

10

11

12

13

14

15

A