

CYLINDRICAL MOUNTINGS • TO 34 kgf



FOR COMPRESSION LOADS OF 18 TO 34 kgf
SHEAR LOADS OF 9 TO 19 kgf

PHONE: 516.328.3300 • FAX: 516.326.8827 • WWW.SDP-SI.COM



► MATERIAL / FINISH:

Fastener - Steel, Zinc Plated
Isolator - Natural Rubber

► NOTE:

Maximum unthreaded portion of stud does not exceed 1.59 mm.

► LOAD DEFLECTION GRAPHS:

Deflections below the line x-x are considered safe practice for static loads; data above that line are useful for calculating deflections under dynamic loads.

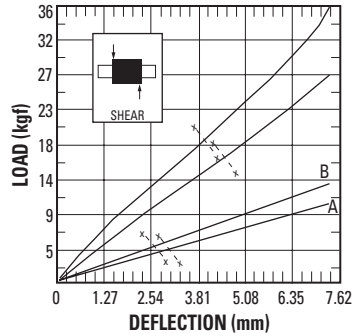
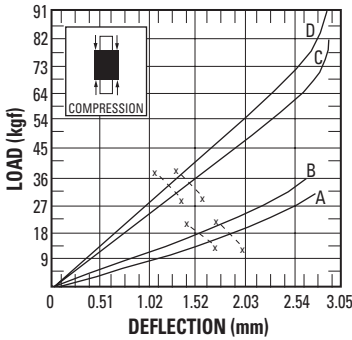
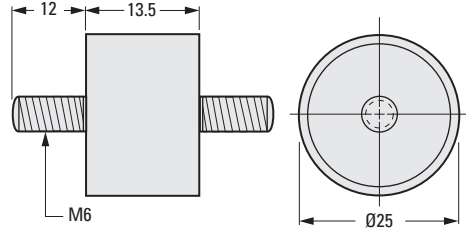

METRIC COMPONENT CATALOG NUMBER

A 1 0 Z 2 M 3 0 5 M 0 6

Load Rating M 0 6
A, B, C or D

Compression		Forcing Frequency in Cycles per Minute									
Load Rating	Maximum Load kgf	1100	1250	1500	1750	2000	2250	2500	2750	3000	3600
		Minimum Load for 81% Isolation (kgf)									
A	18.2	-	-	-	-	13.8	10.9	8.8	7.3	6.1	4.5
B	19.5	-	-	-	-	17.2	13.6	11.3	9.3	7.9	5.7
C	33.6	-	-	-	-	33.6	26.5	21.6	17.9	15	10.7
D	34	-	-	-	-	-	30.6	25.2	20.6	17.5	12.5

Shear		Forcing Frequency in Cycles per Minute									
Load Rating	Maximum Load kgf	1100	1250	1500	1750	2000	2250	2500	2750	3000	3600
		Minimum Load for 81% Isolation (kgf)									
A	8.6	7.1	5.7	3.8	2.9	*	*	*	*	*	*
B	9.5	8.6	7	4.8	3.6	2.9	2.3	*	*	*	*
C	16.8	-	14.3	10.2	7.7	6.4	5.2	4.3	*	*	*
D	19	-	18.1	13.3	10	8.4	7.2	5.9	5	4.3	*

*At these forcing frequencies, lesser loads will yield 81% isolation.