

CYLINDRICAL MOUNTINGS • TO 36 kgf



FOR COMPRESSION LOADS OF 15 TO 36 kgf
SHEAR LOADS OF 8 TO 18 kgf

PHONE: 516.328.3300 • FAX: 516.326.8827 • WWW.SDP-SI.COM



► MATERIAL / FINISH:

Fastener - Steel, Zinc Plated
Isolator - Natural Rubber

► NOTE:

Maximum unthreaded portion of stud does not exceed 1.59 mm.

► LOAD DEFLECTION GRAPHS:

Deflections below the line x-x are considered safe practice for static loads; data above that line are useful for calculating deflections under dynamic loads.

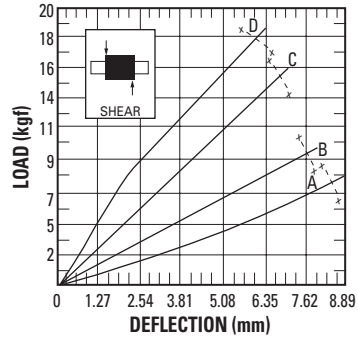
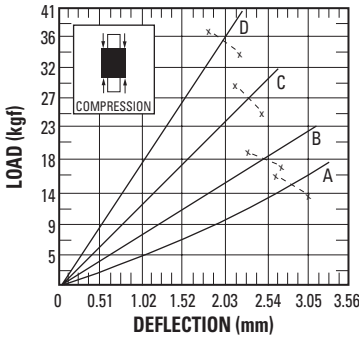
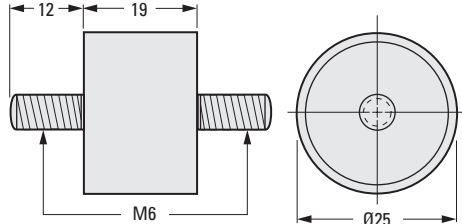

METRIC COMPONENT CATALOG NUMBER

A 10 Z 2 M 300 M 06

Load Rating
A, B, C or D

Compression		Forcing Frequency in Cycles per Minute									
Load Rating	Maximum Load kgf	850	1100	1250	1500	1750	2000	2250	2500	3000	3600
		Minimum Load for 81% Isolation (kgf)									
A	15	-	-	-	13.2	9.5	7.3	5.7	4.8	3.2	2.3
B	18.1	-	-	-	17.9	12.9	9.8	7.7	6.4	4.3	3.2
C	27.2	-	-	-	-	22.2	16.8	13.4	10.9	7.7	5.2
D	35.9	-	-	-	-	32.9	25	19.7	16.3	11.1	7.7

Shear		Forcing Frequency in Cycles per Minute									
Load Rating	Maximum Load kgf	850	1100	1250	1500	1750	2000	2250	2500	3000	3600
		Minimum Load for 81% Isolation (kgf)									
A	8.2	7.3	4.2	3.3	2.3	1.7	1.3	1	0.8	0.5	*
B	9.5	-	5.9	4.6	3.2	2.3	1.8	1.4	1.2	0.8	*
C	15.4	-	11.1	9.1	6.7	5.1	4.1	3.4	2.8	2	1.6
D	18.1	-	14.5	11.8	8.6	6.7	5.5	4.5	3.8	2.7	2.3

*At these forcing frequencies, lesser loads will yield 81% isolation.

8-15
D805

I

R

T

1

2

3

4

5

6

7

8

9

10

11

12

13

14

15

A