

CYLINDRICAL MOUNTINGS • TO 54 kgf



FOR COMPRESSION LOADS OF 19 TO 54 kgf
SHEAR LOADS OF 10 TO 29 kgf

PHONE: 516.328.3300 • FAX: 516.326.8827 • WWW.SDP-SI.COM



► MATERIAL / FINISH:

Fastener - Steel, Zinc Plated
Isolator - Natural Rubber

► LOAD DEFLECTION GRAPHS:

Deflections below the line x-x are considered safe practice for static loads; data above that line are useful for calculating deflections under dynamic loads.

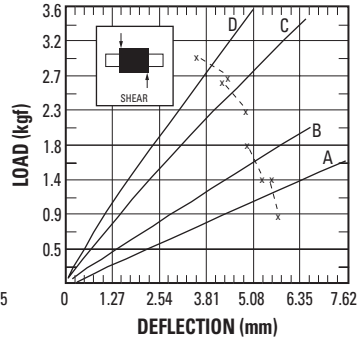
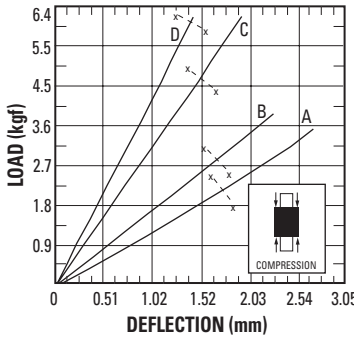
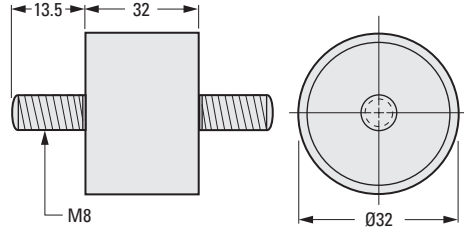
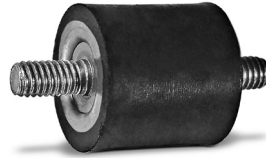

METRIC COMPONENT CATALOG NUMBER

A 10 Z 2 M 310 □ M 08

Load Rating
A, B, C or D

Compression		Forcing Frequency in Cycles per Minute									
Load Rating	Maximum Load kgf	600	850	950	1100	1250	1500	1750	2000	2500	3000
		Minimum Load for 81% Isolation (kgf)									
A	18.6	-	-	-	15.7	12.5	8.6	6.4	4.5	3.2	-
B	29	-	-	-	-	21.8	14.5	10.9	7.9	5.5	3.9
C	40.8	-	-	-	-	36.3	25	18.8	13.6	9.1	6.4
D	54.4	-	-	-	-	-	40.4	32	24	17.5	12

Shear		Forcing Frequency in Cycles per Minute									
Load Rating	Maximum Load kgf	600	850	950	1100	1250	1500	1750	2000	2500	3000
		Minimum Load for 81% Isolation (kgf)									
A	9.5	9.1	5	3.9	3	2.5	*	*	*	*	*
B	14.1	-	8.2	6.4	4.8	3.6	2.5	*	*	*	*
C	21.8	-	14.3	11.3	8.8	7	5	3.9	*	*	*
D	28.6	-	22.7	18.6	14.8	12.5	9.3	7.3	6.4	3.6	*

*At these forcing frequencies, lesser loads will yield 81% isolation.

8-17
D805

- I
- R
- T
- 1
- 2
- 3
- 4
- 5
- 6
- 7
- 8
- 9
- 10
- 11
- 12
- 13
- 14
- 15
- A