

> MATERIAL:
 Cam - Acetal, Black
 Insert - Brass

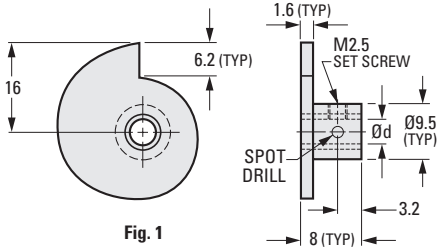

Fig. 1

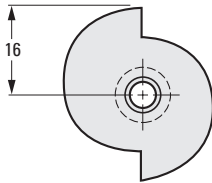

Fig. 2

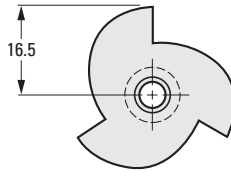

Fig. 3

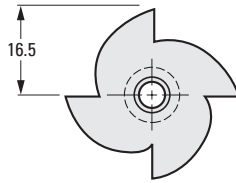

Fig. 4

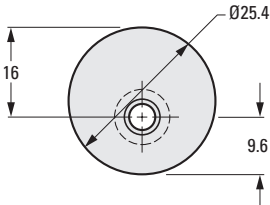

Fig. 5

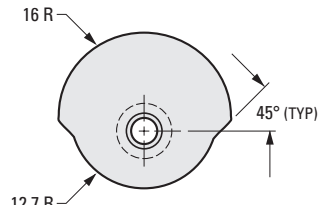

Fig. 6

METRIC COMPONENT

Catalog Number	Fig. No.	d Bore +0.025 0	Rise per 15°
A 3Y 3M1Z03	1	3	0.25
A 3Y 3M1Z04	1	4	0.25
A 3Y 3M2Z03	2	3	0.5
A 3Y 3M2Z04	2	4	0.5
A 3Y 3M3Z03	3	3	0.75
A 3Y 3M3Z04	3	4	0.75
A 3Y 3M4Z03	4	3	1
A 3Y 3M4Z04	4	4	1
A 3Y 3M5Z03	5	3	—
A 3Y 3M5Z04	5	4	—
A 3Y 3M6Z03	6	3	—
A 3Y 3M6Z04	6	4	—