

**PRECISION SERIES
ABEC 5 BEARINGS**

PHONE: 516.328.3300 • FAX: 516.326.8827 • WWW.SDP-SI.COM

> MATERIAL:

- Wheels** - Steel SAE 52100 or 440C Stainless Steel; Both hardened to Rc 60-62 with ground contact edges
- Bearings** - Prelubricated;
Steel - Shielded, Stainless - Sealed

Low and high temperature wheels available on special order.

For engineering assistance for all SDP components, call our application engineering department.

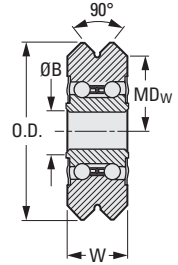
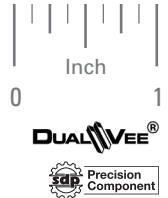
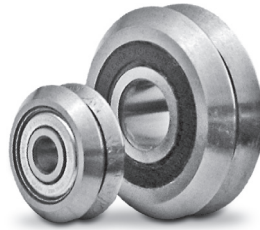

INCH COMPONENT		O.D. Clear.	O.D. (Ref.)	W +.0000 -.0047	B Bore +.0000 -.0003	MDw	Radial Working Load Capacity lbf	Axial Working Load Capacity lbf
Steel	Stainless Steel							
A 7Q16-0	—	.584	.584	.250	.1575	15/64	146	28
A 7Q16-1	A 7Y16-1	25/32	.771	.310	.1875	5/16	274	57
A 7Q16-2	A 7Y16-2	1-1/4	1.210	.438	.3750	1/2	596	141
* A 7Q16-2S	—	1-1/4	1.210	.438	.3750	1/2	596	141
Δ A 7Q16-3	A 7Y16-3	1-25/32	1.803	.625	.4724	3/4	1326	382
Δ A 7Q16-4	A 7Y16-4	2-3/8	2.360	.750	.5906	1	2181	900

* This item has sealed bearings.
Δ Bores conform to metric sizes.

ECONOMY SERIES

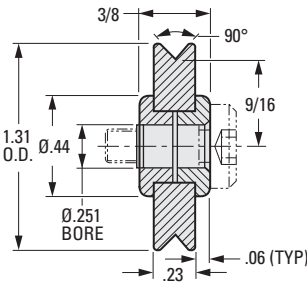

Fig. 1 (Inch)

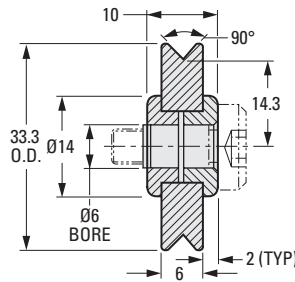

Fig. 2 (Metric)

INCH COMPONENT				
Catalog Number	Fig. No.	Bore	Wheel Material	Bearing Type
A 7Z16-2	1	.251	Acetal	Sintered Bronze
A 7Z16M3	2	6mm	Acetal	Sintered Bronze